

THREE MILE LAKE NEWS

MAY 2016 – VOLUME 9, NUMBER 1

P.O. Box 482, PAW PAW MI 49079

WWW.THREEMILELAKEPAWPAW.ORG

E-MAIL: THREEMILELAKEPAWPAW@YAHOO.COM

2016

BOARD OF DIRECTORS

RON CICCHINI

PRESIDENT

TERM EXPIRES 2016

269-657-5096

DILLON PRESTON

VICE PRESIDENT

TERM EXPIRES 2016

815-993-6057

JIM CHLADA

TREASURER

TERM EXPIRES 2017

708-610-2065

JILL HARRING

SECRETARY

TERM EXPIRES 2018

269-657-3767

MILLIE PAWLOWSKI

DIRECTOR

TERM EXPIRES 2018

630-977-9796

RICH MAXWELL

DIRECTOR

TERM EXPIRES 2016

269-657-7343

CHARLIE BEAR

DIRECTOR

TERM EXPIRES 2018

269-657-7590

MEARL HUNT

DIRECTOR

TERM EXPIRES 2017

269-657-2140

JOYCE BEEDIE

DIRECTOR

TERM EXPIRES 2017

269-657-4409



LETTER FROM THE PRESIDENT

Dear Three Mile Lake Neighbors,

Winter is gone. Spring is here. Boats are already on the lake. Fishermen are fishing. It will not be long before we'll be swimming again. The lake is in great shape.....and the level is up, too.

The 2015 Water Quality Report from PLM can be seen on our website under the Lake Management section.

Let's remember some of our basic rules:

-  Have your renters respect your neighbors' property.
-  Post a copy of boating rules for your renters.
-  Boating safety should be a top priority.

More good news!! The association membership fee is still only \$20.00 per family, per year. Send your check in today. Use the form included with this news letter.

If you have any questions, suggestions or comments on how to make the lake association better, please call any of the Directors or Board Members. Our phone numbers are in this newsletter and on the website: www.threemilelakepawpaw.org.

Enjoy the lake. Be safe.

Ron Cicchini

Michigan's Free Fishing Weekends: An annual tradition

Two days twice a year, families and friends can enjoy one of Michigan's premiere outdoor activities, Michigan Fishing, for FREE! The 1st weekend was in February.

The **2016 SUMMER FREE FISHING WEEKEND** is scheduled for: June 11 & 12.

So grab a pole and your family and friends, and let's go fishing!

(Reprinted from DNR Web Page)



WHO NEEDS TO TAKE A BOATER SAFETY COURSE?

Michigan conservation officers and Michigan county sheriffs encourage all persons operating boats in Michigan to enroll in a boating safety course.

Personal Watercraft

Those less than 14 years of age may not legally operate a PWC.

Those 14 and 15 years of age may operate a PWC legally **only if** they have obtained a boating safety certificate and:

⚓ He or she is accompanied on board by his or her parent or legal guardian or by a person at least 21 years of age who has been designated by the parent or legal guardian or:

⚓ He or she is operating or riding the PWC at a distance of not more than 100 feet from his or her parent or legal guardian or from a person at least 21 years of age who has been designated by the parent or legal guardian.

Those at least 16 years of age and born after December 31, 1978, may operate a PWC legally **only if** they have obtained a boating safety certificate.

Those born on or before December 31, 1978, may operate a PWC legally without restrictions.

<http://www.vanburencountysheriff.com/marine-patrol.htm#classes>

2016 BOATERS SAFETY CLASSES

ALL Classes start at 8:00 a.m.

June 4, Saturday, starts at 8 a.m.
Columbia Township Hall
Sponsored by
Saddle & Silver Lake Associations
53053 CR 388
Grand Junction, MI
Sign up ON LINE ONLY

June 11, Saturday, starts at 8 a.m.
Sister Lakes Fire Department
92282 CR 690,
Dowagiac, MI 49047
Sign up ON LINE ONLY

There are usually more classes available but the above are the ones shown on the Van Buren County Sheriff's website now. You can sign up for the above classes or check to see if others are available at
<http://www.vanburencountysheriff.com/marine-patrol.htm#Classes>

BOATING RULES SPECIFIC TO THREE MILE LAKE

(From the Van Buren County Sheriff's website)

RUSH LAKE AND THREE MILE LAKE - R281.780.1 - Water skiing hours.

1. On the waters of Rush lake and Three Mile lake, Van Buren county, state of Michigan, no operator of any motorboat shall have in tow, or shall otherwise assist in the propulsion of, a person on water skis, water sled, surfboard, or other similar contrivance during the period from 7:30 p.m. to 11:00 a.m. of the following day.

LITTLE THREE MILE LAKE AND PORTION OF THREE MILE LAKE - R281.780.2

High-speed boating and water skiing prohibited.

2. On the waters of Little Three Mile Lake and on that part of Three Mile Lake south of the south eighth line of section 21, T3S, R14W, Van Buren county, state of Michigan, no operator of any motorboat shall:

- (a) Operate such motorboat at high speed.
- (b) Have in tow, or shall otherwise assist in the propulsion of, a person on water skis, water sled, surfboard, or other similar contrivance.

It is the responsibility of the water craft operator to know these laws!

I. SPEED LIMITS

1. Slow – no wake speed within **100 feet** of the shoreline, any watercraft, pier, person, raft, swimming area, and swimmers.
2. Maximum speed **55 M.P.H.** in all water unless otherwise regulated.
3. Michigan law states that a person operating a vessel shall operate it in a careful and prudent manner and at such a rate of speed so as not to unreasonably endanger the life or property of any person. A person shall not operate a vessel at a rate of speed greater than will permit him, in the exercise of reasonable care, to bring the vessel to stop within an assured clear distance ahead.
4. A person shall not operate a vessel in a manner so as to unreasonably interfere with other persons lawfully using Michigan's water resources.

SLOW – NO WAKE! Means operating at a very slow to speed in order to minimize the wake created by your vessel.

II. TOWING OF PERSONS

1. No water skiing between one hour after sunset and one hour prior to sunrise. (BUT SEE RULES SPECIFIC TO THREE MILE LAKE ABOVE FOR OUR HOURS)
2. At least one competent person, in addition to the driver, shall be in any boat towing persons on water skis, sleds, – etc. This additional person shall be in a position to observe the progress of the person being towed.
3. The tow boat must be equipped with a 170 degree wide angle rear view mirror affixed to permit the driver to observe the progress of the person being towed.

III. DISTANCE BETWEEN PERSONS BEING TOWED AND OTHER OBJECTS

Vessels and persons being towed on water skis, water sleds, etc. shall maintain a distance of **100 foot** from any dock, raft, buoyed or occupied bathing areas, or vessels moored or at anchor, except when the vessel is proceeding

at a slow-no wake speed or when water skiers are being picked-up or dropped off.

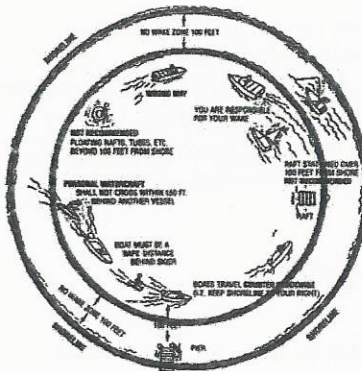

IV. COUNTER-CLOCKWISE OPERATIONS

Persons operating vessels shall operate in a **counter-clockwise** fashion when it reasonably possible.

V. NOISE LEVEL OF BOATS

Motorboats are required to have mufflers or an underwater exhaust system such that it does not produce sound levels in excess of 90 dB when subjected to a stationary (neutral) sound level test of its engine at no closer than one meter (3.3 feet).

VI. CHILDREN OPERATING MOTORBOATS

1. Persons under 12 years old operating motorboats:
 - Must be under the direct supervision of a person 16 years of age or older; and,
 - the boat must have no more than 35 HP.
2. Persons 12 through 15 years may operate motorboats if either condition below is met;
 - Accompanied by at least one person 16 years or older, or, the person has a boating safety certificate.
3. Any person may operate a motorboat that is powered by a motor of no more than 6 HP.
4. As of October 1, 2011, a person of **less than fourteen (14) years of age** may not legally operate a PWC under any circumstances.
5. A person who was born after December 31, 1978 shall not operate a PWC on Michigan waters unless they have obtained a boating safety certificate.

VII. LIQUOR AND / OR CONTROLLED SUBSTANCES

1. A person who is intoxicated (as defined in the same way as for driving a car) may not operate or be in control of any vessel. The Michigan implied consent law applies for boat operator intoxication testing. Severe fines and/or jail time await those who are observed operating a water craft while intoxicated on alcohol or drugs (legal or illegal).

VIII. OPERATION OF VESSELS

1. Sailboats have the right-of-way to motorboats while they are under sail power.
2. Motorboats shall give way to non-motorized vessels.
3. When two vessels are approaching each other head-on, or nearly so, the operator of each shall cause his vessel to pass on the port (left) side of the other (i.e. keep the approaching boat to your left).
4. When overtaking a vessel proceeding in the same direction, the operator of the overtaking vessel, unless it is not feasible to do so, shall pass on the port (left) side of the vessel ahead (i.e. keep the overtaken boat to your right).
5. When two vessels are approaching each other at right angles or obliquely so as to involve risk of collision, the operator of the vessel which has the other on his own port (left) side shall hold his course and speed, and the operator of the vessel which has the other on his own starboard (right) side shall give way to the other by directing his course to starboard so as to cross the stern of the other vessel or, if necessary to do so, shall slacken his speed, stop or reverse.

All vessels are required to provide at least one United States Coast Guard approved PERSONAL FLOTATION DEVICE per passenger. Each child under the age of 6 years, and in an open deck area is REQUIRED by law to wear a PFD AT ALL TIMES!

IX. RESPONSIBILITY FOR VESSEL WAKE

The owner of any vessel is personally responsible for any damage to life or property resulting from a wake or swell created by the negligent operation of the vessel, where the vessel is being operated with his consent. Always maintain safe speeds and follow no-wake laws.

X. DISTANCE FROM SCUBA DIVER'S FLAG

A vessel shall not be operated within 200 feet of a buoyed diver's flag unless it is involved in tendering the diving operation. A person diving shall stay within a surface area of 100 feet of a diver's flag.

XI. PERSONAL WATERCRAFT REGULATIONS

1. A person shall maintain a distance of 100 ft. from any dock, boat, raft, buoyed or occupied bathing area while driving at other than slow – no wake speed.
2. A person shall not cross within 150 ft. behind another vessel other than a personal watercraft, that is moving at greater than a slow – no wake speed.
3. A person shall not operate a PWC on the waters of this state from one hour before sunset to 8:00 A.M local time.
4. Maneuvers that endanger life, limb, or property, including weaving through congested traffic, jumping the wake of another vessel or turning unnecessarily close to another other vessel and/or swerving at the last moment to avoid a collision constitutes reckless operation of a vessel.
5. Carrying more persons than the vessel is designed to carry is prima facie evidence of reckless operation of a vessel.
6. Lanyards must be attached to the operator on vessels that are equipped with lanyards.
7. As of October 1, 2011, a person of less than fourteen (14) years of age may not legally operate a PWC under any circumstances.
8. A person who was born after December 31, 1978 shall not operate a PWC on Michigan waters unless they have obtained a boating safety certificate.
9. A personal watercraft shall not be operated at speeds in excess of (55 mph) except where otherwise posted.
10. A person shall not operate a PWC in waters less than two feet deep unless traveling at a slow no-wake speed.

A complete handbook of Michigan Boating Laws and Responsibilities is available for free download on the internet at www.boat-ed.com.

WEBSITE ADVERTISING

If you have goods or services for sale, or are selling or renting your home and want to advertise on the Three Mile Lake Association website, please contact Web Site Coordinator Joyce Beedie at 269-657-4409. Members - Free. All others \$20.

KEEP INFORMED ABOUT WHAT IS HAPPENING AROUND THE LAKE

If you are not currently receiving emails from the Three Mile Lake Association and would like to be added to the list, please include your email address on your membership form, or email Jim Chlada at jimchlada@comcast.net. We periodically send updates to lake owners when something

is going on around the lake, (eg. when the lake is being treated, etc.)

NEW NEIGHBORS?

If you know of a new neighbor, please contact the Ron Webber at 708-743-7938.

Also please let them know about the Lake Association.

LAKE TREATMENT SCHEDULE





See attached schedule. During weeks when treatment is scheduled, watch for signs that may be posted near the lake about possible restrictions for swimming or watering.

BOARD OF DIRECTOR'S MEETING

The Board of Directors will be meeting in May (date to be determined). If anyone has any issues that need to be addressed, or wishes to participate on the nominating committee to nominate new directors, audit committee to review the financial records, or picnic committee to help organize the picnic, contact one of the board members or email us at threemilelakepawpaw@yahoo.com.

JULY MEMBER MEETING & PICNIC: Date Pending
IF YOU WOULD LIKE TO VOLUNTEER TO HOST THE PICNIC THIS YEAR, PLEASE CONTACT ONE OF THE DIRECTORS.

Items to be discussed:

-  Nominate & vote on Director positions expiring in July 2016.
-  Review status of lake treatment
-  Discuss concerns of lake owners
-  Review and approve 2015 Financial Report
-  Meet new neighbors at the picnic

Be sure to check out our website for events, minutes, lake reports, rules, etc at
www.threemilelakepawpaw.org.

DIRECTOR TERMS EXPIRING THIS YEAR

Each year the terms of 3 Board of Director members expire and are up for election for a 3-year term. We welcome new nominations to the Board of Directors to be voted on at the annual meeting held at the summer picnic. If anyone is interested in joining the Board, please contact one of the current Directors or email threemilelakepawpaw@yahoo.com.

THANK YOU to these member families for their financial support of OUR lake association in 2015.

Deborah & Bob Adams	Gay & Joe Silder
Sheri & Charlie Bear	Amy & Jeff Smith
Mary Jane & Ronald Baylor	Eleanor & Paul Staniszewski
Joyce & Mark Beedie	Doris & Bill Sternbaugh
Shary & Ed Belfy	Denise & Paul Struve
Nancy & Greg Benefiel	Janice & Charles Studer
Cindy & Tom Birkhold	Michele & Octavio Urbietta
Mary & Neil Boff	Beth Wade
Pam Bower	Peggy & David Warmack
Janice & Dale Boone	Gwyn & Ron Weber
Jack Burbridge	Barbara & Terry Wolonik
Diane & Jim Chlada	William Woodman & Linda
Sheri & Tony Chlada	Woodman Toliusi
Sue & Ron Cicchini	Theresa Zona
Renea & David Cotnoir	
Richard Decrocker	
Cheryl DeHaan	
Victoria & James DeYoung	
Joanne & Thomas Duhn	
Robert & Paula Fisher	
Gerald Fitzgerald	
Geanie & Larry Franklin	
Laurie & Theodore French	
J. Craig Gies	
Heather Gordon	
Jill & Roland Harring	
Patsy & Keith Harring	
Betsy & Charles Hill	
Deborah & Bruce Hill	
Diane & Earl Hocking	
Pauline & Mearl Hunt	
Chris & Rich Jones	
Margaret Kenny	
Sue & Paul Kolenko	
Judy Kolman	
Marilyn & Barry Kuchenreuther	
Carolyn Linnert	
Emily & Charles Leuin	
Charlotte & Tom Makowski	
Kristen Mandigo	
Dorothy & Jeffrey Martin	
Nancy & Rich Maxwell	
Dawn & Tim McFarland	
Patsy & Dr. Meachum	
Lynn Meyers	
Joan & Roy Miller	
Connie & David Neilsen	
Patricia & Michael O'Brien	
Sharon & Jim Paluch	
Millie & Tom Pawlowski	
Jennifer & Robert Perkins	
Kristian & Tara Popp	
Catherine Preston	
Kerry & Jeffrey Preston	
Lori & Joe Priola	
Pat & Tim Sanders	
Kay & Jerry Schultz	

INSTITUTE FOR FISHERIES RESEARCH
DIVISION OF FISHERIES

LAKE INVENTORY MAP

THREE MILE LAKE

AREA 178 ACRES

MARGINAL SURVEY AND SOUNDINGS 2/3/40

VAN BUREN COUNTY

T. 3 S., R. 14 W., SEC. 29, 31, 20

AREA 37 ACRES

AREA 139 ACRES

LEGEND

BOTTOM

- Sand
- Pulpy peat
- Fibrous peat

SHORE FEATURES

- Collage
- Dock
- Boathouse
- Unimproved road
- Improved road
- Marsh
- Brush
- Wooded
- Partly wooded
- Pasture
- Cultivated

OUTLINE & CONTOURS

- Shoreline
- Contours

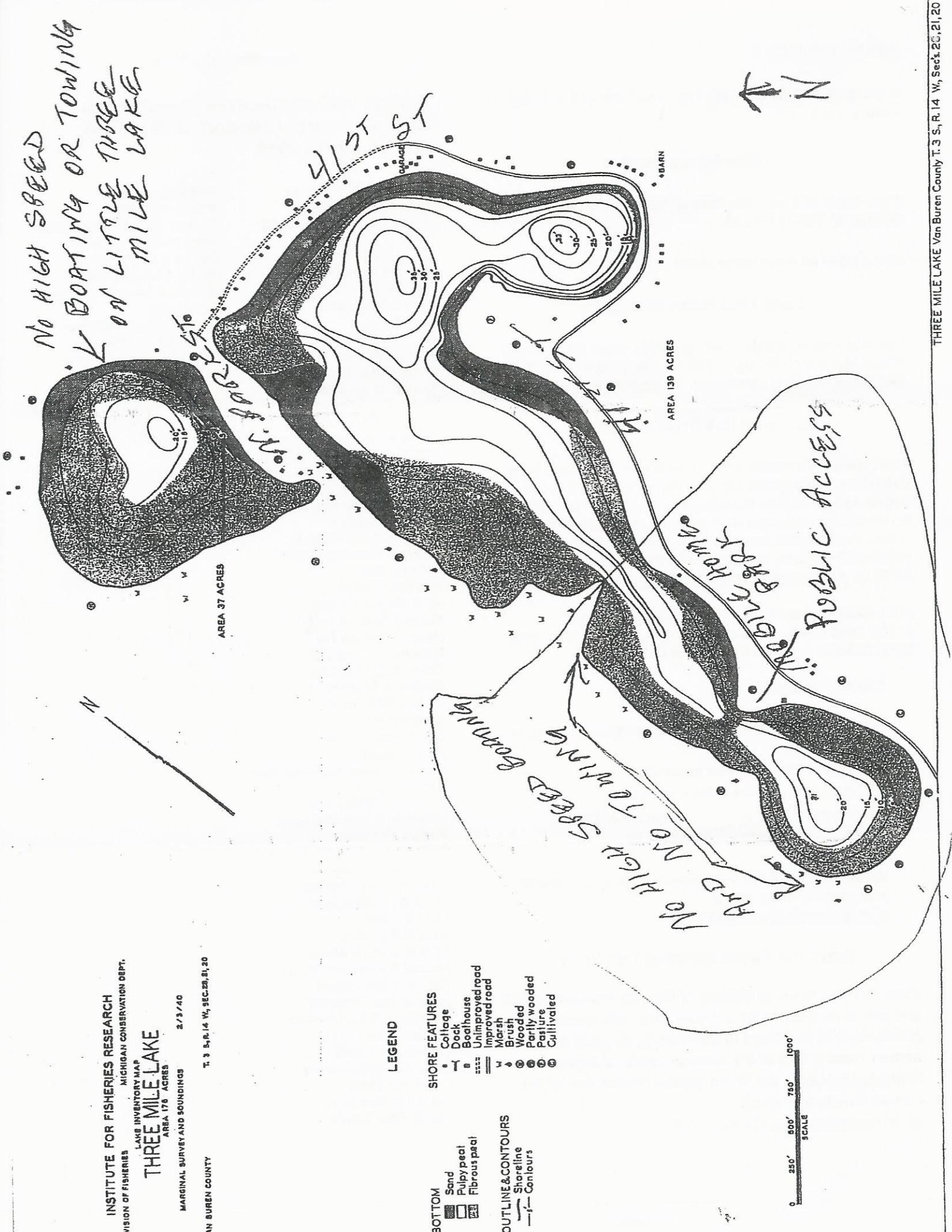

NOTICE 2016

PLM Lake and Land Management Corp
8865 100th St. SE, Alto, MI 49302
(616) 891-1294(o) (616) 891-0371(f)
www.plmcorp.net



Three Mile Lake has been scheduled for the week of:

Date	Description	Date	Description
		6/20/2016	Weed & Algae Treatment
4/4/2016	Water Quality	7/18/2016	Weed & Algae Treatment & E.coli
5/2/2016	Survey	8/15/2016	Weed & Algae Treatment & Water Quality
5/23/2016	Weed & Algae Treatment	9/5/2016	AVAS Survey & Phrag Optional

DEQ permitting restrictions, national holidays, and/or weather conditions may influence the timing of treatments throughout the 2016 season. PLM treats each lake according to a schedule or season plan, established with the cooperation of your lake association, lake board or residents on the lake. The treatment schedule is approximate. Please watch your shoreline for the posting of the 8.5x11 inch, yellow or green signs. The signs will indicate the date of the treatment, the products used, and any restrictions on the use of treated water for swimming, watering lawns, etc. The property owners in this area are planning to have the waters chemically treated to control lake weeds and/or algae. This notice is being circulated in accordance with Department of Environmental Quality (DEQ) procedures. Below is a list of herbicides that may be applied to the lake and the associated use restrictions. On the day of treatment, signs will be posted along the shoreline within 100 feet of treatment areas that indicate what products were used and specific water use restrictions that apply:

Check all that apply	Chemical product/active ingredient	Chemical trade name	Do Not Use this water for swimming or bathing until	Do Not Use this water for ornamentals or turf irrigation until	Do Not Use this water for domestic purposes or agriculture irrigation until	Do Not Use this water for livestock watering or similar purposes until
X	Glyphosate	Aqua Pro, Aquaneat	1 Day(s)	N/A	N/A	N/A
X	Endothall	Aquathol K, Hydrothol 191	1 Day(s)	N/A	14 Day(s)	14 Day(s)
X	Flumioxazin	Clipper	1 Day(s)	3 Day(s)	5 Day(s)	N/A
X	Imazapyr	Habitat	1 Day(s)	120 Day(s)	120 Day(s)	N/A
X	Chelated Copper Herbicide	Komeen, Komeen Crystal, Nautique	1 Day(s)	N/A	N/A	N/A
X	Triclopyr liquid	Renovate 3	1 Day(s)	120 Day(s) or until approved assay indicates 1ppb or less; No restriction for established turf/grasses	120 Day(s) or until assay indicates 1ppb or less. N/A on domestic	See product label
X	Triclopyr/2,4-D amine	Renovate Max G	1 Day(s)	Site-specific recommendation* No restriction for established turf/grasses	120 Day(s) or until assay indicates 1ppb or less triclopyr and 100 ppb or less 2,4-D. N/A on domestic	See product label
X	Triclopyr granular	Renovate OTF	1 Day(s)	Site-specific recommendation* No restriction for established turf/grasses	120 Day(s) or until assay indicates 1ppb or less. N/A on domestic	See product label
X	Diquat Dibromide	Reward, Tribune	1 Day(s)	3 Day(s)	5 Day(s)	1 Day(s)
X	2,4-D amine Sculpin	Sculpin G	1 Day(s)	Site-specific recommendation* No restriction for established turf/grasses	N/A on domestic; assay indicates levels under 100ppb at the water intake	See product label
X	Carfentrazone-Ethyl	Sting Ray	1 Day(s)	14 Day(s)	14 Day(s)	1 Day(s)
X	PLM Blue, Cygnet Select: water dye (tracer), Copper Sulfate Alonglife: copper sulfate, Citrine Plus-Ultra, Captain-XTR, Algimycin, Earthtec, SeClear and SeClear G, Formula F-30, K-Tea: chelated copper, Cygnet Plus, PolyAn: Adjuvant, Pak 27, AquaSticker, Green Clean L and Green Clean 5.0: oxidizer, AquaPrep: enzymes & non-ionic surfactants, Nutrisorb,, M.D. pellets: gram negative, naturally occurring bacteria. PLM Enzyme: enzymes, Phoslock: phosphorus locking technology.					No Restrictions on swimming, bathing, irrigation, domestic purposes or livestock watering.

For a complete listing of all product labels, please see our website.

N/A= Not Applicable INDEF= Indefinite

*Site-Specific recommendations to limit ornamental irrigation with Renovate & Sculpin granular treated water will typically last 2-14 days. Contact PLM for further information.

The chemicals used for Aquatic Nuisance Control are registered by the U.S. Environmental Protection Agency and the Michigan Department of Agriculture. The potential for damage to fish and other non-target organisms is minimal provided that the product is used as directed on the product label and the permit. To minimize the possible effects on health and the environment, the treated water is restricted for the above purposes.

PLM Lake & Land Management Corp. Certified Applicators: Salvatore Adams, Jason Broekstra, Jim Chatel, Jaimee Conroy, Bill D'Amico, Jeff Fischer, BreAnne Grabill, Dustin Grabill, Benjamin Halbersma, Steve Hanson, Jake Hunt, Nate Karsten, Justin Krueger, Blake Mallory, Michael Pichla, James Scherer, Ben Schermerhorn, Casey Shoaff, Lucas Slagel, Jeff Tolan, Andy Tomaszewski, Dennis Vangessel, Mathew Warddell

This is Michigan Law!!!

Your association must forward this to all riparians! Tentative treatment dates and notice of products to be applied must be given to all riparians not more than 45 days before and at least seven days prior to the initial treatment.